

## Computer Monoblock I9 Aio Pc 23.8 Desktop All In One 9.5mm Dvd All In One Computer

Our Product Introduction

for more products please visit us on [allinonepccomputers.com](http://allinonepccomputers.com)

### Basic Information

- Place of Origin: Guangdong, China
- Brand Name: WPNA
- Certification: CE/FCC/RoHs/ISO9001/CCC
- Model Number: L22/L24
- Minimum Order Quantity: 10 units
- Price: Negotiable
- Packaging Details: carton, bubble bag, stretch film
- Delivery Time: 15-30 WORKDAYS
- Payment Terms: D/A, D/P, T/T, L/C, Western Union, MoneyGram
- Supply Ability: 10000 Piece/Pieces per Month



### Product Specification

- Product Name: Integrated Desktop
- Size: 21.5 Inch/23.6 Inch Optional
- OS: Compatible With Win7/8/10/11/Linux
- CPU: Intel I3/I5/I7
- Memory: 4G/8G/16G/32G Optional
- Hard Dish: 128G/256G/512G/1TB /2TB Optional
- Panel Type: IPS
- Interface Type: DVI, HDMI, VGA, USB, DC, AUDIO
- Display Resolution: 1920x1080
- Plugs Type: US, JP, CN, AU, UK, EU
- After-sales Service: Call Center And On-line Technical Support
- Highlight: **9.5mm Dvd All in One, I9 Aio Pc All in One, Desktop All in One**



### More Images



## Product Description

### 23.6 " Best Type Of Desktop Computer Intel Core I3 I5 I7 Gaming Pc With Competitive Price All In One Pc

#### Application

The network game: Easy to play many kinds of popular networks game, enjoy your time.
Graphic design: Strong performance, fast load large type files, easy to run all kinds of graphic design software.
Business office: Appearance fashionable atmosphere, suitable business office of enterprises and units, all kinds of office software run smoothly.
Home entertainment: A stunning visual and audio experience, make your entertainment more enjoyable.

#### Selling points

Space-saving, simple and beautiful: The all-in-one computer combines the host and the display into one, which is suitable for users with limited desktop space. At the same time, the appearance is simple and stylish, which enhances the overall aesthetics.

Convenient installation and simple operation: The all-in-one computer is ready to use out of the box, without complicated assembly and cable connection, which is especially suitable for users who are not familiar with computer hardware and is more convenient to use.

Stable performance to meet daily needs: The all-in-one computer has stable performance and can smoothly handle daily tasks such as office and entertainment. It also supports graphic design and light games to meet diverse needs.

#### Product Characteristics

Ultra-thin office and home computers, light and thin design, the most advanced form of desktop computers.  
Save desktop space, reduce complex wiring, and only need one power cord to start the computer.  
Support wall mounting.

#### Products Description

This all-in-one computer, with its fascinating high-definition display and streamlined ultra-thin frame, creates an immersive visual feast for you. Different specifications meet different space and visual needs, and support personalized configuration. You can choose high-performance independent graphics cards and other components according to your own usage scenarios. Whether it is browsing high-definition web pages, immersing in the world of games, or efficient multitasking, this all-in-one computer that combines elegance and power can easily handle it. Equipped with cutting-edge technology, it is not only a technological product, but also a capable partner to improve the quality of your digital life.

#### Service

1. Metal and electronic double factory linkage:

Cost advantage: self-production of core components, quality assurance and cost reduction at the same time

Rapid delivery: rapid sampling of metal structural parts, 72 hours to assemble the whole machine.

2. Meet industry customization and provide OEM/ODM services

It only takes 15 days from drawings to actual product production, supporting all kinds of computer customization: server/edge computing equipment/OEM whole machine customization/ODM OEM production, providing customers with one-step carton customization.

Phase 1: Customers make requirements, and the factory customizes the appearance of the chassis

Phase 2: The computer factory makes compatibility adjustments such as software

Phase 3: Synchronous production, high delivery efficiency.

3. No need to worry about after-sales issues:

Efficient, professional, and quick response: Equipped with a professional after-sales team, we can quickly respond to customer needs and provide efficient solutions after you consult from us.

Accurate solutions and technical guarantees: We provide accurate technical support and maintenance services for different problems until the problems are completely solved.

All-round services, considerate and thoughtful: We provide all-round services such as product consultation, usage guidance, and troubleshooting when you need it.

Customer first, win-win cooperation: With customer satisfaction as the purpose, we continuously improve service quality and establish long-term and stable cooperative relationships with customers.

#### Products Parameter

Model	I24
Size	23.8inch
Main Board	HM87
Processor	I3-4000M,I5-4200M,I5-4300M,I7-4600M
Memory	4G,8GDDR3
LAN	Gigabit Ethernet
Audio	Stereo Sound Output
USB	2*USB3.0,4*USB3.0
Graphics Card	Integrated Graphics Card

Hard Disk	64G,128G,256G,512G
Color	Orange
Adapter	12V7A
Camera	1.0 MP
Operating System	WIN7/10/11/Linux
Bluetooth	Optional
Resolution	1920*1080
Speaker	High fidelity sound speaker



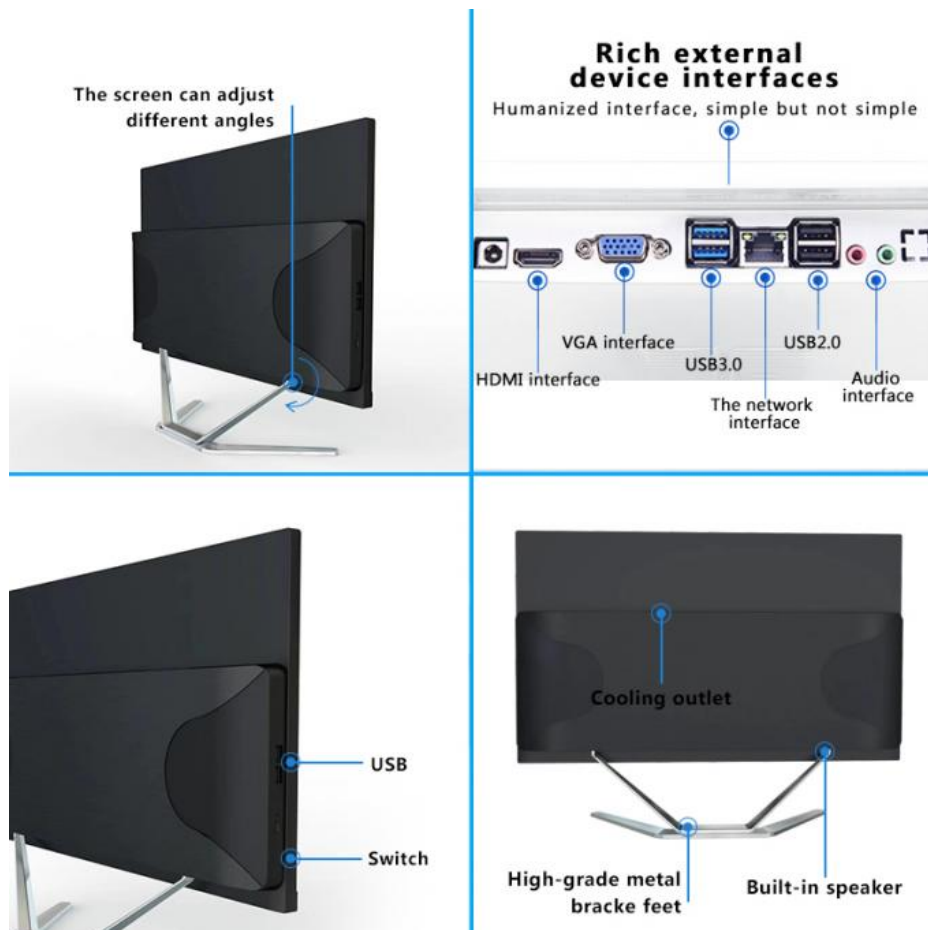

## Company Information

Guangzhou Weipuna Technology Development Co., Ltd. is a factory manufacturer that mainly produces advanced high technology products of R & D, manufacturing and sales of all-in-one computer, mini pc, touch screen monitor, smart teaching & conference panel and laptop computer. Under joint efforts of our professional R & D technology team, we will commit to manufacturing and providing more high end products to global market in the future.

### Core Expertise:

Specializes in the R&D, manufacturing, and sales of advanced high-tech products.

Key product lines include all-in-one computers, mini PCs, touch screen monitors, smart teaching & conference panels, and laptop computers.

### Innovation-Driven:

Backed by a professional R&D team dedicated to continuous innovation and technological advancement.

### Global Commitment:

Focused on delivering high-end, cutting-edge products to the global market.

### Future Vision:

Committed to expanding its product portfolio and enhancing manufacturing capabilities to meet evolving market demands.

### Quality Assurance:

Ensures superior product quality through rigorous R&D and state-of-the-art manufacturing processes.

### Customer-Centric Approach:

Aims to provide tailored solutions and reliable products to meet diverse customer needs worldwide.







## Certifications



## Packing & Shipping

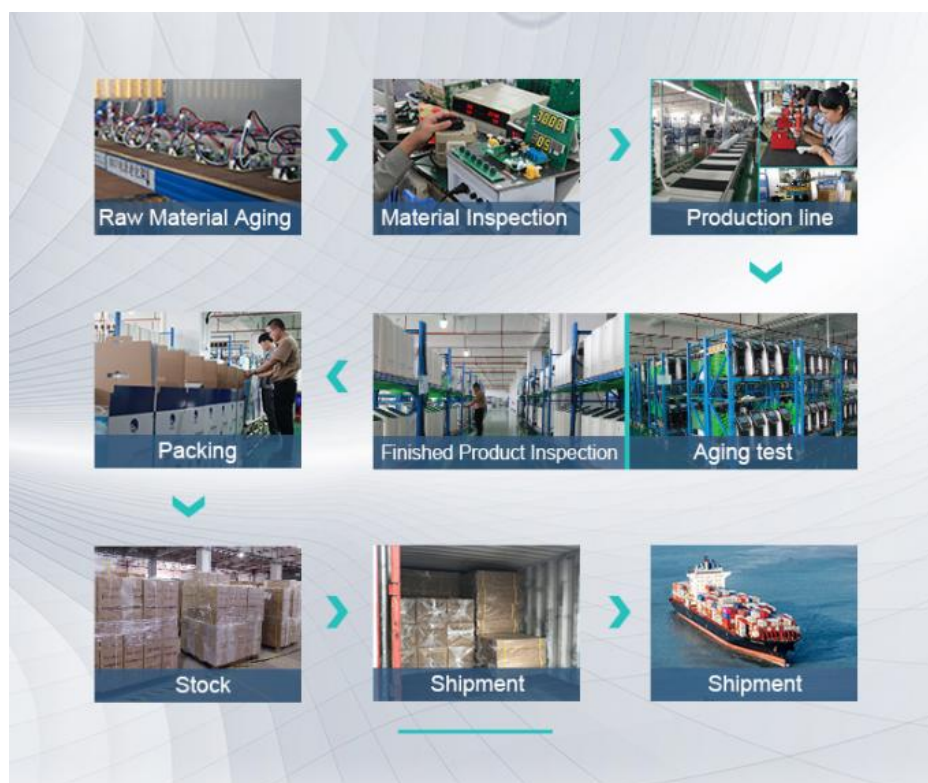





## FAQ

### Question 1:

Can you put my brand name (logo) on these products?

Yes. We can support **OEM/ODM** service, the process of customization is following:

1:provide your specific requirement.

2:our design engineer draw the design draft.

3:you confirm the design draft.

4:we start produce it.

**Question 2:**

How much do I need to pay for your OEM service?

over 50units we can support printing logo for you, over 100units we can custom shell and packing box for you.  
(about the OEM service fee is the customer pay)

**Question 3:**

What payment method do you accept?

**T/T, Western Union, Cash and as you required.**

**Question 4:**

What is the Minimum Order Quantity(MOQ)?

We can sell one piece sample for your test.

**Question 5:**

What is the lead time of your products?

1-3 days for one sample, 15 working days for a large quantity.

## Recommend Products

---



**Guangzhou Weipuna Technology Development Co., Ltd.**



+86 135 4430 6128



allinonepccomputers.com

4th Floor, Building B7, Huachuang Animation Industrial Park, No. 9, Huateng Road, Shiji Town, Panyu District,  
Guangzhou City, Guangdong Province, China